

Novia® FR Pro A1 Breather Membrane is a Class A1 fire rated, strong, high performance wall breather / façade membrane. The membrane is suitable for use in traditional low-rise insulated wall applications, as well as in high rise and high risk buildings, having achieved an EN 13501-1 Class A1 Fire Classification. The membrane is non-smoke-emitting in the event of a fire, facilitating safer evacuation during fire emergencies. **Novia® FR Pro A1** is CE marked and meets EN 13859-2 for walls. It also meets EN 13111 Class W2 water resistance and provides high breathability. **Novia® FR Pro A1** is a speckled green-grey coated woven glass-fibre membrane, with no text or images.

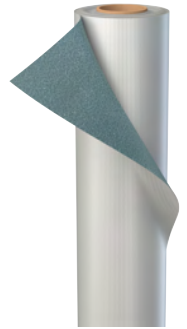

Example Construction

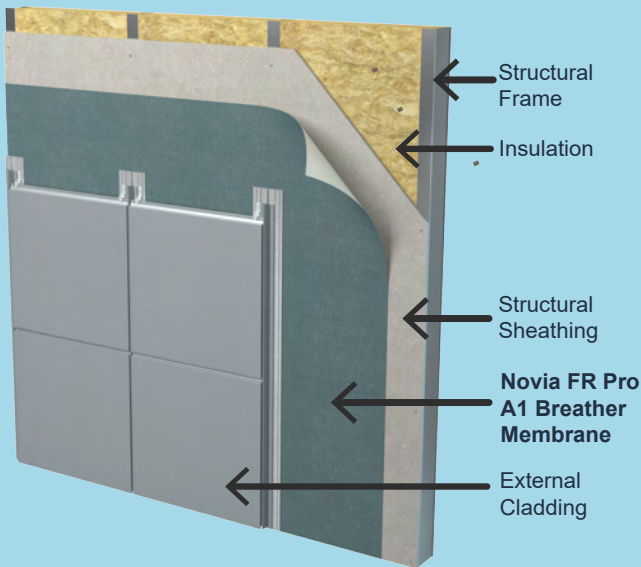

Key Features:

- Class A1 Fire Rated to EN 13501-1, suitable for use in high rise & high risk applications
- Non-smoke-emitting membrane, for safer evacuations
- Class W2 water resistance to EN 13111
- Vapour permeable and highly breathable
- CE to EN 13859-2 for wall applications

We manufacture a comprehensive range of EN 13501-1 Class A and Class B internal AVCL membranes / external Breather membranes, for use in high-rise and high-risk applications. See our website for further product details.

	Value	Units	Test Method
Standard Width	1.5	m	
Roll Length	50	m	
Roll Weight	19	kg	
Nominal weight	232	g/m ²	EN 1849-2
Tensile strength MD / CD	2350 / 2025	N/50mm	EN 12311-1
Elongation MD / CD	4.3 / 3.0	%	EN 12311-1
Resistance to tearing MD / CD	120 / 130	N	EN 12310-1
Water vapour resistance, Sd	0.1	m	EN ISO 12572
Resistance to water penetration	W2	Class	EN 13111
Resistance to water penetration (after ageing)	W2	Class	EN 13111
Reaction to fire	A1	Class	EN 13501-1



Use the QR code to link direct to the product webpage.





FR Pro A1

Class A1 Fire Rated

Wall Breather / Façade Membrane



Installation Guidance for Walls:

Novia® FR Pro A1 should be mechanically fixed to the wall structure, upper layers should overlap lower layers, with the green-grey coloured coating facing outwards, towards the exterior cladding. Work from the bottom moving upwards, using minimum overlaps of 100mm on the horizontal joints. Do not begin a vertical lap joint within 300mm of a corner, and vertical laps should be at least 150mm. Ensure the bottom of the structure is also protected by an overlap. Fix at suitable intervals with galvanised or stainless steel fixings (or similar) that will be permanent. Do not leave the membrane unnecessarily exposed to weathering, high winds, excessive UV etc. as this will cause damage over time. The membrane should be exposed for the least amount of time as possible. If the membrane is to be exposed for extended periods of time, suitable temporary protection materials must be used.

Installation Tapes:

We strongly advise the use of Novia installation tapes¹. The use of tapes will greatly improve the performance and overall airtightness of the structure. We offer a single-sided **Novia® Breather Membrane Lap Tape (BMLT)** for basic installations, and for high specification work, where there is even greater emphasis on air-tightness, we offer the optional **Novia® Double Sided Lap Tape (DSLTL)**. For the very best standards of installation and air-tightness, we advise the use of both types of tape, which will ensure a long lasting, high quality, breathable and air-tight seal is formed.

¹ Novia BMLT, UVLT and Novia DSLTL are not fire rated, but tapes & sealants are excluded under relevant sections of "Fire Safety: Approved Document B".

Other Notes:

- **Novia® FR Pro A1** should be installed with the green-grey coloured coating facing outwards, towards the exterior cladding.
- Ensure that a Novia Air & Vapour Control Layer, such as **Novia® FlamePro A1 VCL** is installed on the warm side of the insulation to limit unwanted interstitial condensation. As little as 1% - 3% moisture contamination within the insulation can adversely affect the achieved thermal performance by more than 30%.
- Where necessary, ensure that sufficient ventilation is incorporated to comply with all relevant building regulations.
- Always handle material carefully to prevent tears and punctures. Repair any on-site damage with Novia tapes.
- All Novia products should be stored horizontally, indoors and out of direct sunlight. External storage must be on a temporary basis. When stored externally, Novia products should be covered and protected from exposure to weather conditions, especially wind, rain, frost and UV. Pallets should not be stacked.

This datasheet represents the latest understanding of the subject. However, it is for the ultimate user to determine suitability of Novia products within specific applications. The advice and information we have provided is general in nature, and is subject to future revision.

Date Published: V1, April 2026. Novia's most recently published datasheet supercedes any previous versions which may still be in circulation.

DS0426_FRProA1